

□ DC515 XX

Contents **DE** Inhalt **FR** Contenu **NL** Inhoud **FI** Sisältö
 UK Inhold **IT** Contenuto **ES** Contenido **PT** Conteúdo
GR Περιεχόμενα **SE** Innehåll



x1



x1



x2



x2

CR2032



x2



x1

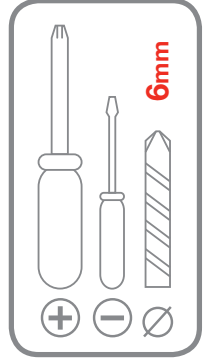

x1

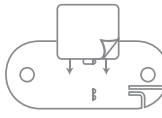

x1



x2



x2

CR2032



x2



x1

Getting started **DE** Erste Schritte **FR** Démarrage **NL** Aan de slag **FI** Aloitusopas **UK** Kom i gang
IT Operazioni preliminari **ES** Para empezar **PT** Para começar **GR** Πρώτα βήματα **SE** Kom igång

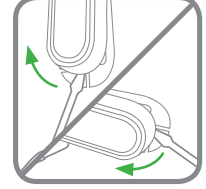
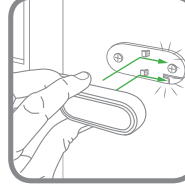
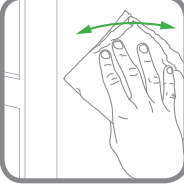
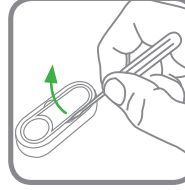
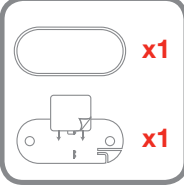
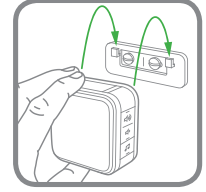
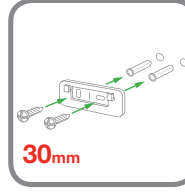
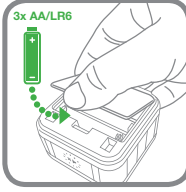
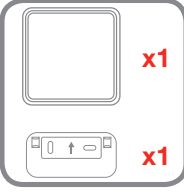
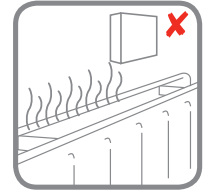
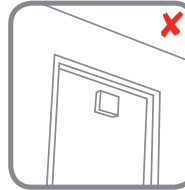

GB Optional features 05 Optionale Funktionen 06 Options disponibles 07 Opções disponíveis 08 Valinnaiset ominaisuudet 09 Valgfrife Funktionen 10 Funzionalità opzionali 11 Opciones disponibles
 PT Funções opcionais 02 Προαιρετικές λειτουργίες 03 Μόλιγα funktioner



	Hello	Ding Dong	Westminster	Marimba	Piano	Bell	Telephone	Soft Alert
	•	•					•	•
	•	•	•	•			•	•
	•	•	•	•	•	•	•	•

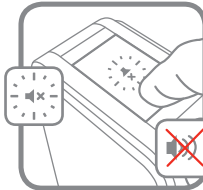
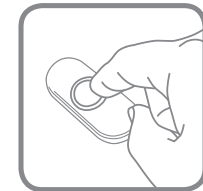
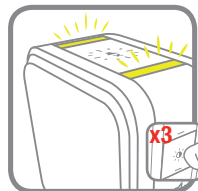
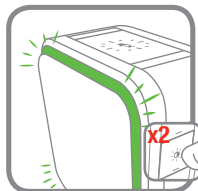
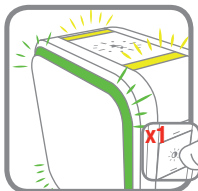
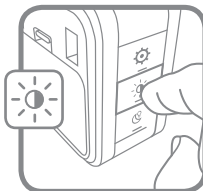

GB Linking 05 Einlernen 06 Programmation 07 Forbinde
 08 Verknüpfung 09 Linkittäminen 10 Forbinde
 11 Coligamento 12 Enlace
 PT Programação 06 Ουδέσση 05 Länkning

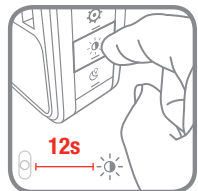
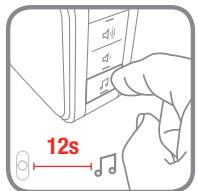
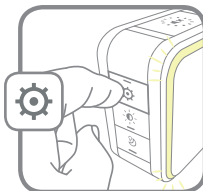

GB Trouble shooting 09 Fehlerbehebung 04 Dépannage 11 Probleemoplossing
 FI Vianmääritys 04 Problemlösning 11 Risoluzione die problemi 13 Solución de
 problemas 07 Resolução de problemas 08 Αντιμετώπιση προβλημάτων 09 Felsökning

livewell.honeywell.com

